

Digital Microscope
DSX1000

Quick Reference Guide



AX9342 04

Basic

Contents

- (1) Introduction
- (2) Preparation for observation
- (3) Selection of observation modes
- (4) Image processing method
- (5) Image acquisition
- (6) Saving acquired images

Introduction

User interface

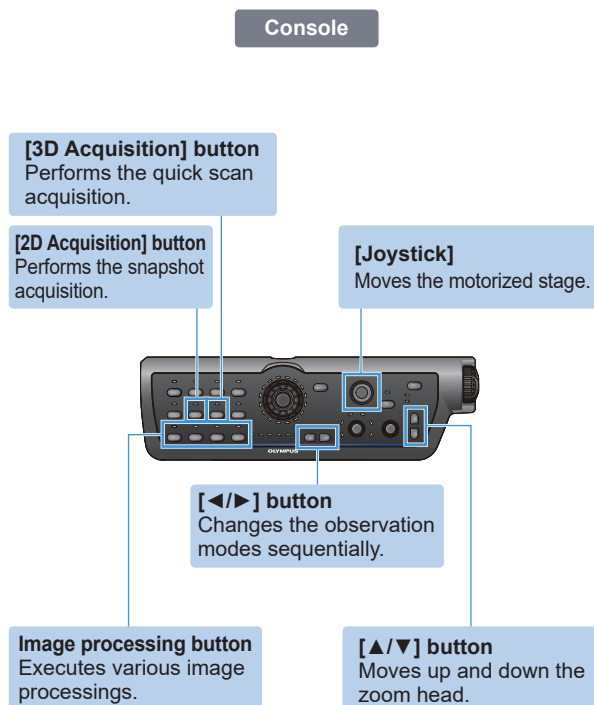
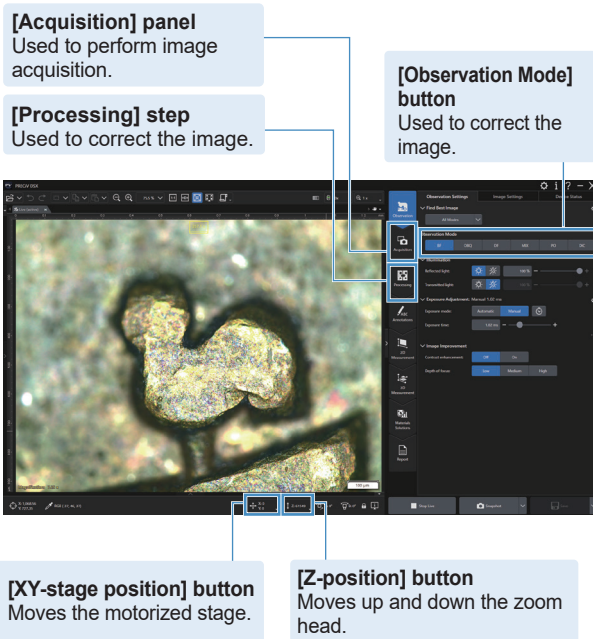

Preparation for observation

Sample set

1. Start the system (in a state of bright-field observation).
2. Set a sample on the stage.
3. Move the zoom head to bring the sample into focus.
4. Move the stage back/forth and left/right to place the position desired to be observed on the center.



Useful operation

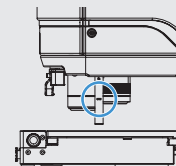

* Pulling out the Focus assist bar helps you to roughly find the focus point.

Software

3. **[Z-position] button**
Moves up and down the zoom head.

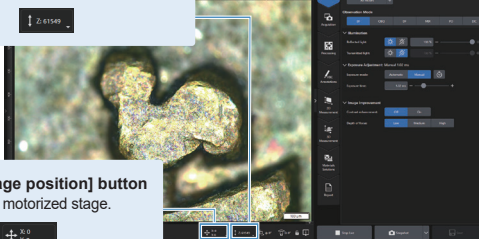

4. **[XY-stage position] button**
Moves the motorized stage.

Console

3. **[▲/▼] button**
Moves up and down the zoom head.



4. **[Joystick]**
Moves the motorized stage.

* For "Up/Down movement of zoom head", "Back/Forth and Left/Right movement of stage", and "Usage of Focus assist bar", please refer to the online help.

Selection of observation modes

Select the best image

1. Activate the [Observation] step and click on the [Observation Settings] tab.
2. Click the [All Modes] button from the [Best image screen] group.
3. Select the desired image on the best image screen.
4. Click the [Apply] button.

Software

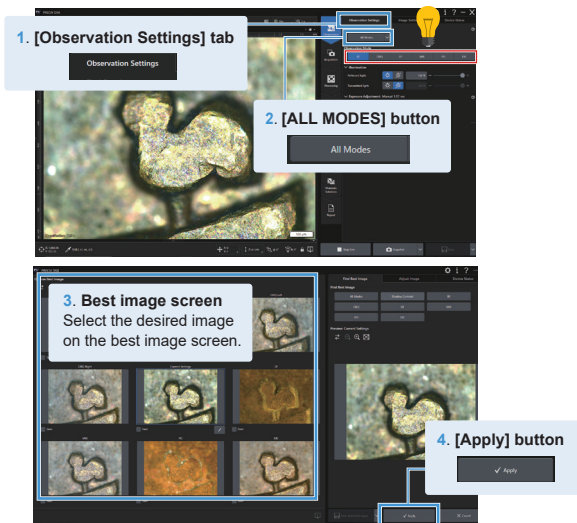

Useful
operation

Console

* Direct observation mode is also available.



[◀▶] button
Changes the observation modes
sequentially.



[Observation mode] button
Changes to the appropriate
observation mode.

Image processing method

Live image processing is available

[Increasing the Contrast] [Increasing the Depth of focus]

1. Activate the [Observation] step and click on the [Observation Settings] tab.
2. Select the required settings in the [Contrast enhancement] field or [Depth of focus] field in the [Image Improvement] group.

[Enhance Texture / Remove Halation]

1. Activate the [Observation] step and click on the [Observation Settings] tab.
2. Click the [LiveHDR] button in the [Image Enhancement] group.
3. Select the [Enhance Texture] or [Remove Halation] in the [Options] field.

Software

1. [Observation Settings] tab

2. [Contrast enhancement] field or [Depth of focus] field

3. [Enhance Texture] or [Remove Halation] button

1. [Image Settings] tab

2. [LiveHDR] button

Console



Image processing button
Executes various image processings. When the image processing is enabled, the corresponding LED lights up.

Texture enhancement

Enhances the uneven state.

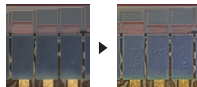

Contrast UP

Enhances the contrast.

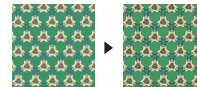

Anti-halation

Curbs various reflections.

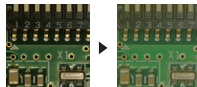

Depth of focus UP

Deepens the focusable distance.

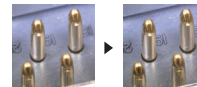

Useful operation



* Clicking the [Accessory] tab - [Live measurement] button enables you to perform the measurement during the live operation. For details, please refer to the online help.

Image acquisition

2D Acquisition and 3D Acquisition
can be easily conducted

2D Acquisition

1. Activate the [Acquisition] step and click on the [Observation Settings] tab.
2. Click the [Snapshot] button.
A new document is created and displayed in the document group.

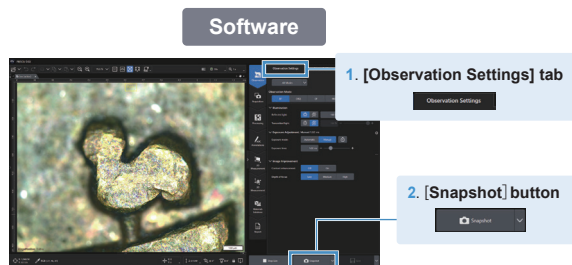

3D Acquisition

1. Activate the [Acquisition] step and click on the [Single Postions] tab.
2. Click the [EFI/3D] button in the [Acquisition Mode] field, and click the [Quick Scan] button in the [Mode] field.
3. Click the [Start] button.
A new document is created and displayed in the document group.

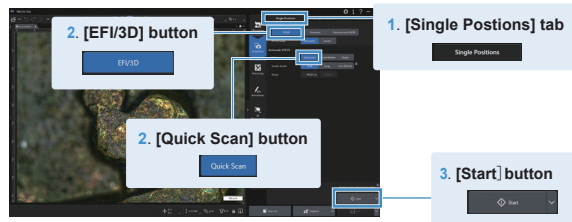

Saving acquired images

Saving the image data

1. Click the [Save] button.
2. The image is saved.

Assigns default names when acquiring images.

You can change this name in the [Document Name] dialog box.

See [Acquisition Settings] > [Document Name] dialog box.

Software

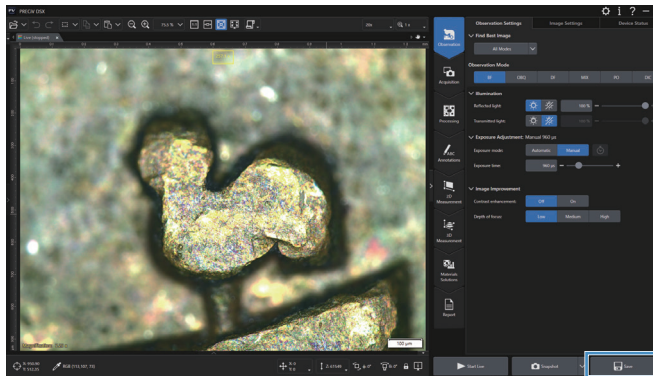

1. [Save] button



Useful operation

- Desire to designate the name of a file desired to be automatically saved
Advanced settings > Image acquisition > [Auto save]



Digital Microscope
DSX1000

Quick Reference Guide



Advanced

Contents

- (1) Operation of tilt observation
- (2) Operation of Rotatable stage
- (3) Replacement of objective and option unit
- (4) List of objectives and corresponded observation modes
- (5) Objectives and attachment management
- (6) Items often referred in the Instruction Manual
- (7) Configuration of the Instruction Manual

Operation of tilt observation

1. Click the [Z-position] button in the status bar, then click the [Eucentric Position] button. Or press the [Tilt Position] button on the console.

Software

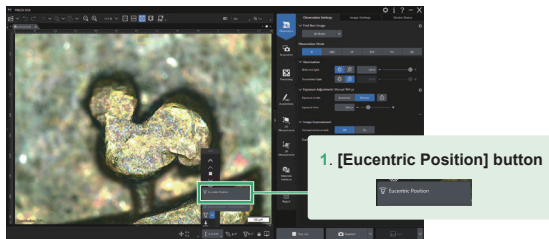

Console



2. Adjust the focus with the Focusing knob

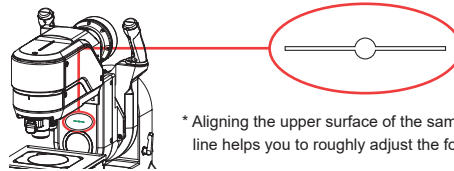

3. Rotate the Tilting lock lever to release the tilting lock.
4. Tilt the head holding the Rotation-release knob on the head arm.
5. Stop the head at an arbitrary position and release your hand from Rotation-release knob.

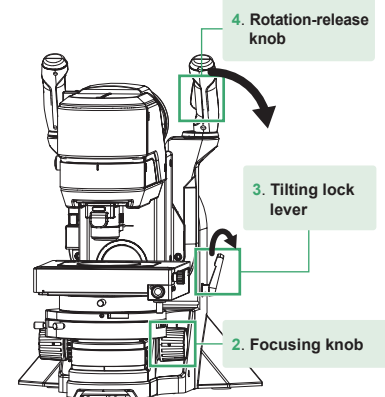

Operation of Rotatable stage

* This function is only for rotatable motorized stage.

1. Loosen the Rotation release knob.
2. Rotate the stage holding the Stage rotation knob.

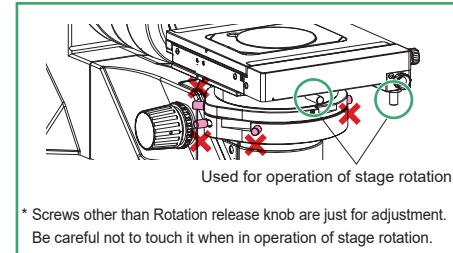
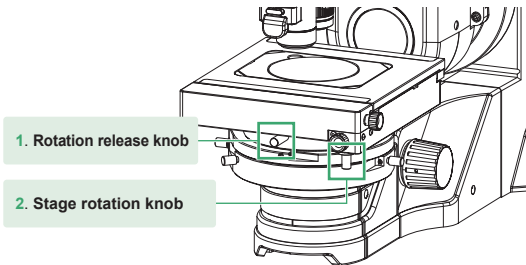

Software

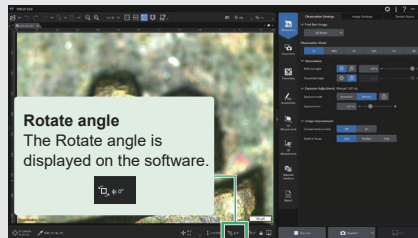

Console



* With the stage rotated, you can move the stage back/forth and left/right with joystick.

Replacement of objective and option unit

Attachment and detachment of lens attachment

1. Insert the unit along the mounting portion and push it all the way until it clicks.
2. Press the Lens attachment replacement button and remove it.

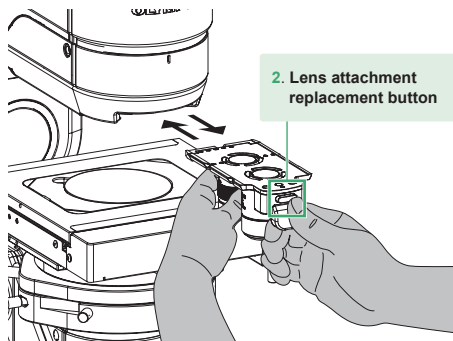

* Please be sure to hold the unit with both hands. Dropping the unit may result in injury.

* An objective lens used for the first time should be registered on the software.

Attachment and detachment of option unit (Diffused illumination adapter)

* This unit can be attached only to Super long working distance objective.

1. Align the groove of the objective lens to the projection of the adapter.
2. Turn the unit clockwise to be mounted until it clicks.
3. Push down the removal button and turn the unit counterclockwise to be removed.

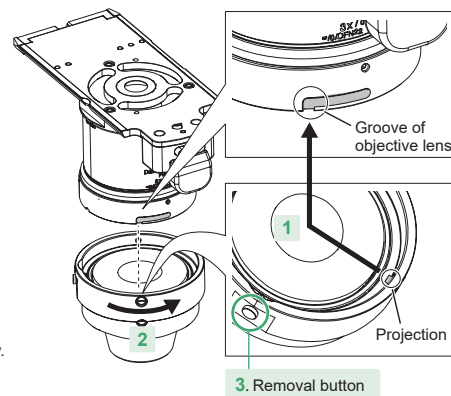

List of objectives and corresponded observation modes

Series name	Objective name	NA	W.D. (mm)	Actual field of view *1 (mm)	BF	BF Oblique	DF Ring	MIX	PO	DIC
Super long working distance objective lens series	DSX10-SXLOB1X	0.03	51.7	2.74 - 19.2	■	□*2	■	■	—	□*2
	DSX10-SXLOB3X	0.09	66.1	0.91 - 9.1	■	■	■	■	—	□*3
	DSX10-SXLOB10X	0.20	41.1	0.27 - 2.74	■	□*2	■	■	—	□*2
Long working distance objective lens series	DSX10-XLOB3X	0.09	30.0	0.91 - 9.1	■	■	■	■	—	□*2
	DSX10-XLOB10X	0.30	30.0	0.27 - 2.74	■	■	■	■	□*3	■
	DSX10-XLOB20X	0.40	20.0	0.14 - 1.37	■	■	■	■	□*3	■
	DSX10-XLOB40X	0.80	4.5	0.07 - 0.69	■	■	■	■	□*3	■
UIS2 Series	MPLFLN1.25X	0.04	3.5	2.19 - 17.1	■	□*2	—	—	—	—
	MPLFLN2.5X	0.08	10.7	1.1 - 10.2	■	□*2	—	—	—	—
	MPLFLN5XBDP	0.15	12.0	0.55 - 5.48	■	■	■	■	■	■
	MPLFLN10XBDP	0.25	6.5	0.27 - 2.74	■	■	■	■	■	■
	MPLFLN20XBDP	0.40	3.0	0.14 - 1.37	■	■	■	■	■	■
	MPLFLN50XBDP	0.75	1.0	0.05 - 0.55	■	■	■	■	■	■
	LMPLFLN10XBD	0.25	10.0	0.27 - 2.74	■	□*2	■	■	□*3	□*2
	LMPLFLN20XBD	0.40	12.0	0.14 - 1.37	■	□*2	■	■	□*3	□*2
	LMPLFLN50XBD	0.50	10.6	0.05 - 0.55	■	□*2	■	■	□*3	□*2
MPLAPON50X	0.95	0.35	0.05 - 0.55	■	■	—	—	□*3	■	

*1 At aspect ratio of standard 1:1 diagonal

*2 Blur or color unevenness may occur

*3 Polarization characteristic may have no effect

■: Applicable

□: Applicable with restrictions

—: Not applicable

Objectives and attachment management

For the management to check which purchased objective lens is mounted to which position of which attachment, please use the following table.

Objective name	Attachment number	Lens position	Note
<input checked="" type="checkbox"/> example	1 · 2	Front / Back	<i>uneven sample, DF observation</i>
<input type="checkbox"/> DSX10-SXLOB1X			
<input type="checkbox"/> DSX10-SXLOB3X			
<input type="checkbox"/> DSX10-SXLOB10X			
<input type="checkbox"/> DSX10-XLOB3X	1 · 2	Front / Back	
<input type="checkbox"/> DSX10-XLOB10X	1 · 2	Front / Back	
<input type="checkbox"/> DSX10-XLOB20X	1 · 2	Front / Back	
<input type="checkbox"/> DSX10-XLOB40X	1 · 2	Front / Back	
<input type="checkbox"/> MPLFLN1.25X	1 · 2 · 3	Front / Back	
<input type="checkbox"/> MPLFLN2.5X	1 · 2 · 3	Front / Back	
<input type="checkbox"/> MPLFLN5XBDP	1 · 2 · 3	Front / Back	
<input type="checkbox"/> MPLFLN10XBDP	1 · 2 · 3	Front / Back	
<input type="checkbox"/> MPLFLN20XBDP	1 · 2 · 3	Front / Back	
<input type="checkbox"/> MPLFLN50XBDP	1 · 2 · 3	Front / Back	
<input type="checkbox"/> LMPLFLN10XBD	1 · 2 · 3	Front / Back	
<input type="checkbox"/> LMPLFLN20XBD	1 · 2 · 3	Front / Back	
<input type="checkbox"/> LMPLFLN50XBD	1 · 2 · 3	Front / Back	
<input type="checkbox"/> MPLAPON50X	1 · 2 · 3	Front / Back	

Items often referred in the Instruction Manual

Items often referred in the Instruction Manual are picked up.
Please use the heading titles as a reference for your searching.

Item		Heading title	Item		Heading title
Precautions for transportation and installation	Hardware manual	"3.1 Transportation", "3.2 Installation"	Acquiring Extended Focal Image	Online help	"Acquisition > Acquiring EFI images"
Maximum loading capacity on stage	Hardware manual	"5.3 Loading capacity of stage"	Acquire wild-field mages	Online help	"Acquisition > panorama images"
Restrictions on combination	Hardware manual	"6. List of combinable units"	Acquiring images at multiple positions	Online help	"Acquisition > Acquiring images at multiple positions"
Cleaning and storage method	Hardware manual	"7. Maintenance and Storage"	Basic elements of User interface	Online help	"About the User interface"
Unit assembly method	Hardware manual	"8. Assembly"	Glossary and links	Online help	"Glossary"

As for items often used, please use the following table for your efficient searching.

Configuration of the Instruction Manual



Instruction Manual - Safety manual

Safety precautions

Please be sure to read this manual before use.



Instruction Manual - Hardware manual

Safety precautions

For the product specifications and assembly method, please be sure to read this manual before use.



Online help

Operational description

If you face any unclear points, including troubleshooting, please refer to this manual.

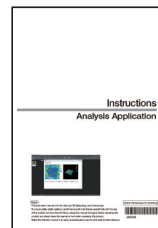

Instruction Manual - Analysis Application

Measuring and analyzing image data using PV-3DAA

Please refer to this manual if you have questions.



Installation Guide



Insertion

Description of cautions and initial setting

Please be sure to read this insertion when opening the product.